

# LCD Temperature Controller USER'S MANUAL

Thank you for purchasing the product. Before using the Temperature Controller, we recommend reading the instructions in advance.

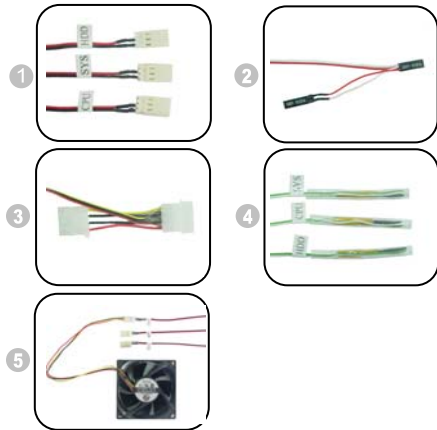

## Mode Setup and Selection

### I • Mode switch:

The Default display of temperature value is CPU temperature, you can switch by pressing (S1) SW. The Display rotation is CPU→SYS→HDD→CPU→.....

### II. Alarm clock function:

Press (S2) SW to turn on/ off.

### III. Full-screen display:

Hold the (S3) SW for 3 seconds. All the icons will display for 4 seconds then return normal mode.

### IV. Changing Temperature Display :

Press (S3) SW to switch 2 mode (°C and °F ) modes.

### V. Setting up the Meter:

#### A. Time & Date adjustment:

- Year: Hold the (S1) SW for about 3 seconds→ "Year" character will flicker→press (S2) SW and (S3) SW to adjust "Year" character.
- Month: Hold the (S1) SW for about 3 seconds→ press (S1) SW once→ "Month" character will flicker→ press (S2), (S3) SW to adjust "Month" character.
- Date: Hold the (S1) SW for about 3 seconds→ press (S1) SW 2 times→ "Date" character will flicker→ press (S2), (S3) SW to adjust "Date" character.

iv. Hour: Hold the (S1) SW for about 3 seconds→ press (S1) SW 3 times→ "Hour" character will flicker→ press (S2), (S3) SW to adjust "Hour" character.

v. Minute: Hold the (S1) SW for about 3 seconds→ press (S1) SW for 4 times→ "Minute" character will flicker→ press (S2), (S3) SW to adjust "Minute" character.

#### B. Adjusting the Alarm clock:

i. Hour: Hold the (S1) SW for about 3 seconds→ press (S1) SW for 5 times→ "Hour" character will flicker→ press (S2), (S3) SW to adjust "Hour" character.

ii. Minute: Hold the (S1) SW for about 3 seconds→ press (S1) SW for 6 times→ "Minute" character will flicker→ press (S2), (S3) SW to adjust "Minute" character.

#### C. Adjusting the Temperature Alarm:

i. CPU temperature alarming: Hold the (S1) SW for about 3 seconds→ press (S1) SW for 7 times→ "Minute" character will flicker→ press (S2), (S3) SW to adjust "CPU" temperature alarm.

ii. SYS temperature alarming: Hold the (S1) SW for about 3 seconds→ press (S1) SW for 8 times→ "Minute" character will flicker→ press (S2), (S3) SW to adjust "SYS" temperature alarm.

iii. HDD temperature alarming: Hold the (S1) SW for about 3 seconds→ press (S1) SW for 9 times→ "Minute" character will flicker→ press (S2), (S3) SW to adjust "HDD" temperature alarm.

**\*REMARK: To increase values press (S2) SW during adjustment, to decrease values press (S3) SW.**

#### Quitting from set up mode:

During any adjustments, if the meter is idle 3 seconds, it will return to normal mode automatically.

## Auto-adjustable Speed Fan Function

1. According to the temperature detected, the temperature will adjust six-level speed of the fan automatically. There are six adjustable levels, the higher temperature is detected, and the faster the fan operates. When temperature is lower than 13 °C, the fan will stop rotating, right now "!" icon will be on. If the sensor is damaged / open circuit / space parity, the fan will work at maximum speed.

2. Invalid fan connections detect function -- The fan icon will not be displayed if without any connections.

3. Fan stuck detect function: If the fan is stuck when you are checking the channel, all the icons (Fans & "!" ) will keep flashing and cease to operate and the fan icon will stop moving.

**Notice:** The differences between CPU fans and other fans ( Front and Rear )

- 1) The sensor for CPU doesn't affect CPU fan.
- 2) This LCD temperature controller doesn't drive CPU fan. Only detect operating conditions/fan connections (Empty connection/Stop moving/Stuck situation)

## Temperature Display and Sensor Assembly

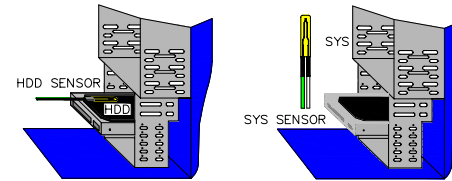

1. Detect temperature of CPU, SYS and HDD apart by three sensors, and display the temperature from degree 0 °C to 100 °C. The inspection tolerance is +/- 5%. When the temperature is lower than 0 °C, the value displays "LO". When the temperature is higher than 100 °C, displays "HI", when transducers have space parity, the value displays " \_ " and the temperature icon will not be shown.

2. The temperature value display can be transferred by switch.

3. Give a discontinuous alarm for one minute when temperature is too high. (The default value of alarming degree is 65 and customers can adjust this value) When temperatures alarm activates, the temperature icon will also flash. The Temperature degree icon (located at the bottom right) displays the high to low temperatures of the selected value (CPU, SYS, or HDD).

Attention:

1. The range of temperature is shown by 10 degrees, from 0~100 °C the icon is divided into 10 portions of degrees to present the temperature of value.

Alarm

Temperature icon:



Temperature

degree icon:



## Temperature Sensors Adhesion Directions

The temperature sensors can be adhered to any part of CPU, EXCEPT THE MICROCHIP AREA.

### CORRECT:

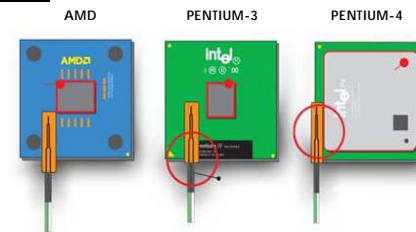

### INCORRECT:

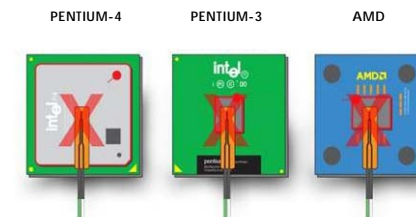

### Attention to users :

1. Do not attach the temperature sensors to the microchip area, or it will affect the cool-down function for CPU and can cause serious damage to your CPU.

## Time Display

1. 24 hrs mode / perpetual calendar.

2. Alarm clock.

## Power LED、HDD LED Introduction and Assemble

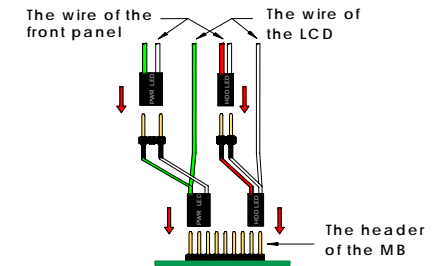

"POWER LED" and "H.D.D LED" show statements of main board: If the board is power on, the light ball icon (instead of POWER LED) will be on. When the hard disk reads the data, the battery icon (instead of H.D.D LED) will light gradually from bottom to top.

## Remark

1. This precise product with hi-tech integrated circuits and transistors, are easily damaged by static. Therefore, we recommend you read the manual carefully before using.
2. The display of LCD Temperature Controller is fragile. Please do careful and discreet when using.
3. The temperature controller adopts two types voltage: +12V (for fans and backlight) and +5V (for whole circuits). In order to keep clock working when power is off, one button battery is installed on the back of PCB.

NZXT. CRAFTED GAMING ARMOR.  
WWW.NZXT.COM